

**CWL-80, CWL-200, CWL-301**

**80-200-300 kg**

- Lightweight and compact design for easy installation
- Dynamic and mechanical ratchet brake provides instant and safe braking
- Operates on standard household power supply
- Wire rope comes with a safety-latch weight hook
- Enclosed drum flanges to prevent rope becoming trapped between drum and support castings
- Emergency stop function switch is available upon request



▲ CWL-80

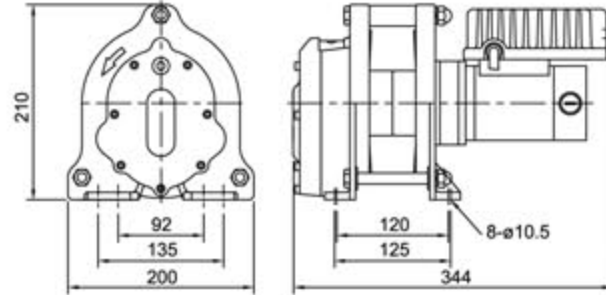

▲ CWL-200



▲ CWL-301

DIMENSION mm/in

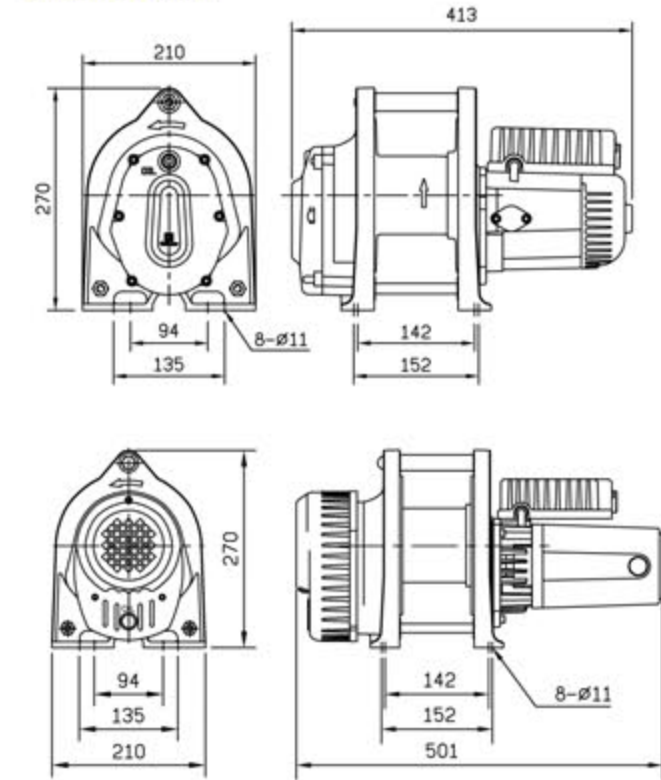

110V or 220V-240V x 1ph AC (CWL-80/200)  
220V-240V x 1ph AC (CWL-301)

**SPECIFICATIONS**

MODEL		CWL-80	CWL-200	CWL-301
Lifting capacity kg wire rope top layer		80	200	300
Lifting speed, m/min	first layer	16	11	16
	top layer	25	16	25
Motor rating IP44	type	Series Wound		
	output, kw x Amp	1ph, 110V 0.3 kw x 6 A	1.2 kw x 12 A	-
		1ph, 220-240V 0.3 kw x 3 A	1.5 kw x 7.5 A	2.3 kw x 11 A
Gear ratio		56:1	240:1	110:1
Maximum lifting height, m		23	45	29
Braking methods	for motor	Electromagnetic		
	for gear	Single mechanical ratchet	Double mechanical ratchets	
Wire rope w/hook	size, mm x m	* 4 x 24	* 5 x 46	* 6 x 30
	construction		6 x 19	
	breaking strength, kg	810	1,270	2,010
	weight hook		CHW-0031	
Drum dimension, mm	length	46	97	97
	drum dia.	70	95	95
	flange dia.	158	190	190
Mounting bolts pattern, mm x mm		120 x 90	142 x 94	
		125 x 135	152 x 135	
Standard accessory	weight hook		*	
	remote control		*	
	power lead	1.5 mm <sup>2</sup> x 3C x 3 m and industry plug		2.0 mm <sup>2</sup> x 6C x 10 m and industry plug
Net weight, kg (standard version)		16	30	38
Gross weight, kg		18	32	40
Body dimension, mm (L x D x H)		344 x 200 x 210	413 x 210 x 270	501 x 210 x 270
Box dimension, mm (L x D x H)		376 x 330 x 240	515 x 395 x 350	630 x 395 x 350

Note: 1. Above performance ratings are based on 50Hz supply.  
(60Hz motor available as option resulting in a reduction of lifting capacities by 20% and a speed increase of 20%)  
2. \*\*\* Means standard version

**SOLUTION for REMOTE CONTROL (CWL-80)**

- \* Remote control, CPB-413
  - Switch cord 1.25 mm<sup>2</sup> x 6C x 3 m
  - Pendant switch CPB-413
- Remote control, PB-317A
  - Switch cord 1.25 mm<sup>2</sup> x 6C x 3 m
  - Pendant switch PB-317A w/an emergency stop button

**SOLUTION for REMOTE CONTROL (CWL-200)**

- \* Remote control, CPB-313
  - Switch cord 1.25 mm<sup>2</sup> x 6C x 10 m
  - Pendant switch CPB-313
- Remote control, PB-417
  - Switch cord 1.25 mm<sup>2</sup> x 6C x 10 m
  - Pendant switch PB-417 w/an emergency stop button

**PERFORMANCE DATA**

Pulling load capacity for various inclines in kg						
MODEL	Level Surface	Gradient % inclines / angle in degrees				
		10%6°	20%11°	40%22°	60%31°	80%39°
CWL-80	670	360	260	170	130	110
CWL-200	1,670	890	650	410	320	280
CWL-301	2,500	1,340	970	620	490	410

- All rating are based on the top layer. For each layer reduction on the drum pulling capacity is increased by 10%
- Use a snatch block for double line operation, to increase line pull by approximately 85%
- The pulling capacities are based on a pulling load and 15% has been allowed for friction (specific applications will vary)

Lifting Capacity, Lifting Speed and Rope Capacity			
MODEL	CWL-80		
Layer of Wire Rope	Lifting Capacity kg	Lifting Speed m/min	Total Rope on the Drum, m
1 <sup>st</sup>	132	16	2.4
2 <sup>nd</sup>	119	17.2	5.1
3 <sup>rd</sup>	108	18.9	8.1
4 <sup>th</sup>	100	20.6	11.3
5 <sup>th</sup>	92	22.3	14.8
6 <sup>th</sup>	86	24	18.6
7 <sup>th</sup>	80	25	24

MODEL	CWL-200		
Layer of Wire Rope	Lifting Capacity kg	Lifting Speed m/min	Total Rope on the Drum, m
1 <sup>st</sup>	320	11	5.8
2 <sup>nd</sup>	291	11.6	12.1
3 <sup>rd</sup>	267	12.6	19.1
4 <sup>th</sup>	246	13.7	26.6
5 <sup>th</sup>	229	14.7	34.7
6 <sup>th</sup>	213	15.8	43.4
7 <sup>th</sup>	200	16	46

MODEL	CWL-301		
Layer of Wire Rope	Lifting Capacity kg	Lifting Speed m/min	Total Rope on the Drum, m
1 <sup>st</sup>	478	16	4.8
2 <sup>nd</sup>	427	17.7	10.2
3 <sup>rd</sup>	386	19.6	16.2
4 <sup>th</sup>	353	21.5	22.7
5 <sup>th</sup>	324	23.4	29.8
6 <sup>th</sup>	300	25	30

Note: Above performance ratings are based on 50Hz supply.

**SOLUTION for REMOTE CONTROL (CWL-301)**

- \* Remote control, CPB-313
  - Switch cord 2.0 mm<sup>2</sup> x 6C x 10 m
  - Pendant switch CPB-313
- Remote control, PB-417
  - Switch cord 2.0 mm<sup>2</sup> x 6C x 10 m
  - Pendant switch PB-417 w/an emergency stop button