

CP-500, CP-500T

500 kg



Electric Winch

200V-240V x 1ph AC (CP-500)
380V-440V x 3ph AC (CP-500T)

- Lightweight and compact design for easy installation
- Electromagnetic spring-applied failsafe brake
- Heavy duty high efficiency ball bearings on all running surfaces
- Planetary gears for maximum mechanical efficiency
- Enclosed drum flanges to prevent rope becoming trapped between drum and support steel plates
- Steel plate foot mountings
- Quiet running
- Emergency stop function switch is available upon request
- Low voltage control ass'y is available upon request

SPECIFICATIONS

MODEL		CP-500	CP-500T
Lifting capacity kg wire rope top layer		500	
Lifting speed, m/min	first layer	10	12
	top layer	15	18
Motor rating IP44	type	Induction	
	output, kw x poles	1ph, 220-240V 3ph, 380-440V	1.8 x 4
Gear ratio		48:1	42:1
Maximum lifting height, m		58	
Braking methods		Electromagnetic	
Wire rope w/hook	size, mm x m	* 7 x 60	
	construction	6 x 19	
	breaking strength, kg	2,700	
Drum dimension, mm	weight hook	CHW-0005	
	length	220	
	drum dia.	102	
	flange dia.	180	
Mounting bolts pattern, mm x mm		267 x 156 ; 267 x 72	
Standard accessory	weight hook	*	
	remote control	*	
Net weight, kg (standard version)		55	54
Gross weight, kg		62	62
Body dimension, mm (L x D x H)		728 x 260 x 299	704 x 260 x 299
Box dimension, mm (L x D x H)		750 x 300 x 380	

Note: 1. Above performance ratings are based on 50Hz supply.
(60Hz motor available as option resulting in a reduction of lifting capacities by 20% and a speed increase of 20%)
2. *** Means standard version

SOLUTION for REMOTE CONTROL

- *Remote control, HOB-213
 - Switch cord 3.5 mm² x 5C x 6 m
 - Pendant switch HOB-213
- Remote control, PB-331
 - Switch cord 3.5 mm² x 5C x 6 m
 - Pendant switch PB-331 w/an emergency stop button
- Low voltage control ass'y LV-320
 - Remote control, PB-306
 - . Switch cord 1.25 mm² x 3C x 3 m
 - . Pendant switch PB-306 w/an emergency stop button
 - Low voltage control, LV-320

PERFORMANCE DATA

MODEL	Pulling load capacity for various inclines in kg					
	Level Surface	Gradient % inclines / angle in degrees				
		10%6°	20%11°	40%22°	60%31°	80%39°
CP-500	4,170	2,230	1,620	1,040	810	
CP-500T					690	

- All rating are based on the top layer. For each layer reduction on the drum pulling capacity is increased by 10%
- Use a snatch block for double line operation, to increase line pull by approximately 85%
- The pulling capacities are based on a pulling load and 15% has been allowed for friction (specific applications will vary)

Lifting Capacity, Lifting Speed and Rope Capacity				
Layer of Wire Rope	Lifting Capacity kg	Lifting Speed, m/min		Total Rope on the Drum, m
MODEL	CP-500 / 500T	CP-500	CP-500T	CP-500 / 500T
1 st	757	10	12	10
2 nd	671	11.6	13.4	22
3 rd	602	12.9	14.9	35
4 th	546	14.2	16.4	50
5 th	500	15	18	60

Note: Above performance ratings are based on 50Hz supply.

DIMENSION mm/in

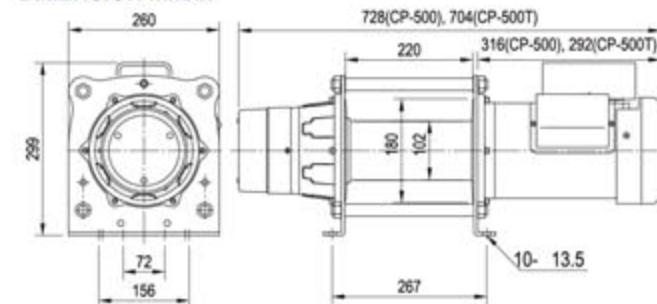

- Low voltage control ass'y LV-320 (CP-500T only)
 - Remote control, CPB-161
 - . Switch cord 1.25 mm² x 3C x 3 m
 - . Pendant switch CPB-161
 - Low voltage control, LV-320

CP-750T

750 kg



Electric Winch

380V-440V x 3ph AC

- Lightweight and compact design for easy installation
- Electromagnetic spring-applied failsafe brake
- Heavy duty high efficiency ball bearings on all running surfaces
- Planetary gears for maximum mechanical efficiency
- Enclosed drum flanges to prevent rope becoming trapped between drum and support castings
- Cast steel foot mountings
- Quiet running
- Rated capacity limiter limits driving power of the motor to prevent overloading of the winch
- Low voltage control ass'y comes as standard
- Emergency stop function switch is available upon request

SPECIFICATIONS

MODEL		CP-750T
Lifting capacity kg wire rope top layer		750
Lifting speed, m/min	first layer	10
	top layer	15
Motor rating IP54	type	Induction
	output, kw x poles	3ph, 380-440V
Gear ratio		58:1
Maximum lifting height, m		58
Braking methods		Electromagnetic
Wire rope w/hook	size, mm x m	* 9 x 60
	construction	6 x 19
	breaking strength, kg	3,750
Drum dimension, mm	length	240
	drum dia.	114
	flange dia.	240
Mounting bolts pattern, mm x mm		300 x 400
Standard accessory	safety-latch hook	*
	remote control	*
	low voltage control	*
	base plate	*
Net weight, kg (standard version)		135
Gross weight, kg		165
Body dimension, mm (L x D x H)		870 x 424 x 360
Box dimension, mm (L x D x H)		970 x 530 x 520

Note: 1. Above performance ratings are based on 50Hz supply.
(60Hz motor available as option resulting in a reduction of lifting capacities by 20% and a speed increase of 20%)
2. *** Means standard version

SOLUTION for REMOTE CONTROL

- *Low voltage control ass'y LV-320
 - Remote control, CPB-161
 - . Switch cord 1.25 mm² x 3C x 3 m
 - . Pendant switch CPB-161
 - Low voltage control, LV-320
- Low voltage control ass'y LV-320
 - Remote control, PB-306
 - . Switch cord 1.25 mm² x 3C x 3 m
 - . Pendant switch PB-306 w/an emergency stop button
 - Low voltage control, LV-320

PERFORMANCE DATA

MODEL	Pulling load capacity for various inclines in kg					
	Level Surface	Gradient % inclines / angle in degrees				
		10%6°	20%11°	40%22°	60%31°	80%39°
CP-750T	6,250	3,350	2,430	1,550	1,210	
					1,040	

- All rating are based on the top layer. For each layer reduction on the drum pulling capacity is increased by 10%
- Use a snatch block for double line operation, to increase line pull by approximately 85%
- The pulling capacities are based on a pulling load and 15% has been allowed for friction (specific applications will vary)

Lifting Capacity, Lifting Speed and Rope Capacity			
Layer of Wire Rope	Lifting Capacity kg	Lifting Speed m/min	Total Rope on the Drum, m
1 st	1,188	10	9.9
2 nd	1,036	11	21.3
3 rd	920	12.4	34.2
4 th	826	13.8	48.5
5 th	750	15	60

Note: Above performance ratings are based on 50Hz supply.

DIMENSION mm/in

